

CA 4585



Peso máx. puerta
Peso max. porta
Max. Door weight



Dos puertas
Duas portas
Two doors



Espesor Madera
Espessura Madeira
Wood Thickness



Ancho mínimo
Largura mínima
Minimum width



Riel U28
Trilho U28
Carrier track U28
*E= 18-22mm



COMPONENTES / COMPONENTES / COMPONENTS

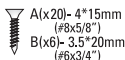
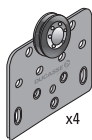

H1 = HV - 51
AP = AV/2 + 25

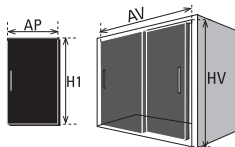

1

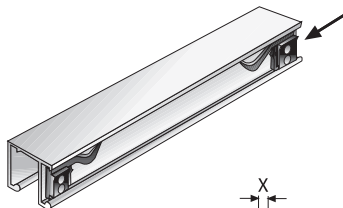

$$X = E - 8$$

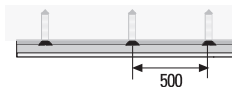
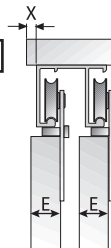

2

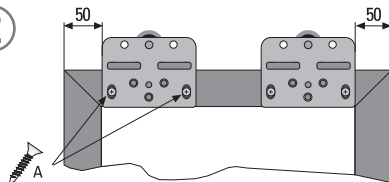

Todas las medidas expresadas en milímetros

Todas as medidas estão em milímetros.

All measurements in millimeters.

mm	Decimal	Aprox Fraction	mm	Decimal	Aprox Fraction
1	0.0394	3/64	6	0.2362	15/64
2	0.0787	5/64	7	0.2756	9/32
3	0.1181	1/8	8	0.3150	5/16
4	0.1575	5/32	9	0.3543	23/64
5	0.1969	13/64	10	0.3937	25/64

3

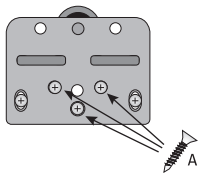

4



1.

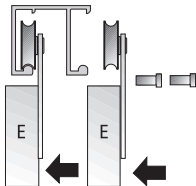

2.

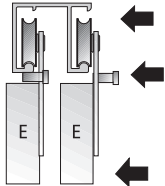

5



6

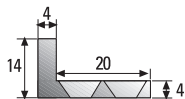

6A

1

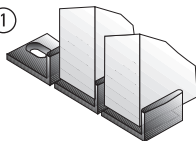

2



3

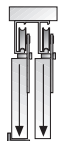
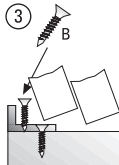

4

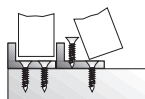

5

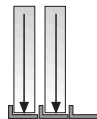
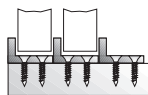

6B

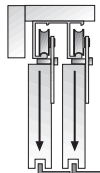
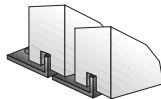
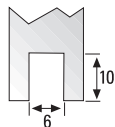

V05.04.18

OP

DUCASSE INDUSTRIAL