

Plegaduc Pro 2 hojas

<p>2x 15 kg 33 lbs</p>	<p>12</p>	<p>≤ 350mm ≤ 13" 25/35</p>	<p>18-25mm 3/4"-1"</p>
<p>Peso puerta Peso porta Door weight</p>	<p>Dos puertas Duas portas Two doors</p>	<p>Ancho puertas Largura portas Doors width</p>	<p>Espesor Madera Espessura Madeira Wood Thickness</p>
<p>23 21</p>	<p>Guía AL CD 50 Guia AL CD 50 Guide Track CD 50 AL</p>	<p>≥ 35mm ≥ 1" 3/8</p>	

COMPONENTES / COMPONENTES / COMPONENTS

x1 (Bracket)
 x3 (Pin)
 x1 (Bracket)
 x1 (Bracket)
 x1 (Bracket)
 x1 (Bracket)
 x1 (Bracket)
 x1 (Bracket)
 x1 (Bracket)

A(x1) - #8x3/4"
 B(x8) - #4x15mm (#8x5/8")
 C(x12) - #3,5x15mm (#6x5/8")
 D(x5) - #10x1"



$$AP = (AV/2) - 3$$

$$HP = HV - 50$$

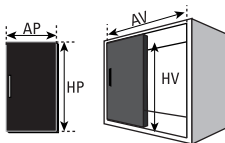

Todas las medidas expresadas en milímetros

	mm	Decimal inches	Aprox Fraction	mm	Decimal inches	Aprox Fraction
1	0.0394	3/64	6	0.2362	15/64	
2	0.0787	5/64	7	0.2756	9/32	
3	0.1181	1/8	8	0.3150	5/16	
4	0.1575	5/32	9	0.3543	23/64	
5	0.1969	13/64	10	0.3937	25/64	

Todas as medidas estão em milímetros.

All measurements in millimeters.

- 1** Instalar el freno antes de fijar el riel al mueble.
 Freio deve ser instalado no trilho guia anteriormente à colocação do mesmo no móvel.
 Insert the stoppers into the track before track installation.

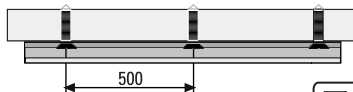
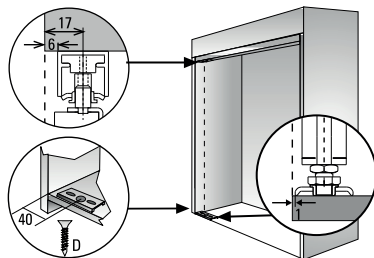
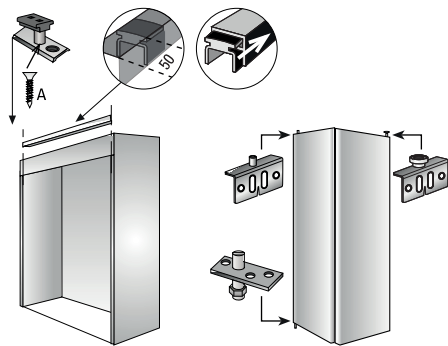

* No incluido.
 * Não incluido.
 * Not included.

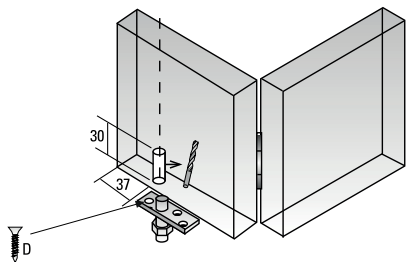
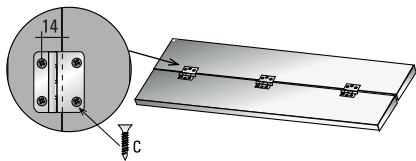
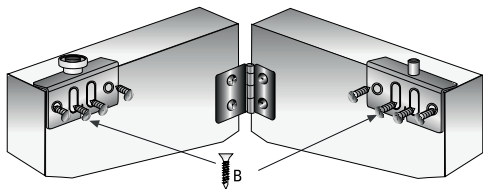
2**3****4**