

CD-50 CXR

2x (15-50kg) 33-110 lbs Peso puerta Peso porta Door weight	12 Dos puertas Duas portas Two doors	18 - 35mm 3/4" - 1"1/8" Espesor Madera Espessura Madeira Wood Thickness	Min. 650 Ancho mínimo Largura mínima Minimum width	Máx. 2400 Altura máx. puerta Altura max. porta Max. Door height
23 21 Guía AL CD50 Guia AL CD50 Guide Track CD50 AL	20 16 Riel AL CD50 CX Trilho CD50 CX Carrier Track CD50 CX	63.5 16 Riel AL Doble CX30 Trilho Duplo CX30 Double Carrier Track CX30	14 6 Riel Embutido CX Trilho Embutido CX Inlaid Carrier Track	≥ 65mm

COMPONENTES / COMPONENTES / COMPONENTS

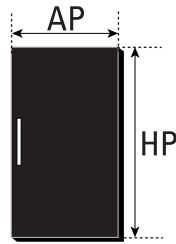
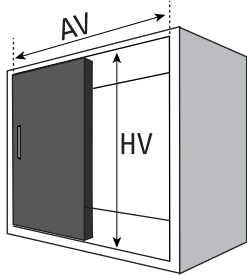
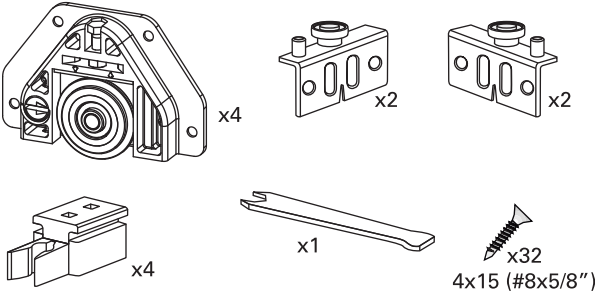

$$AP = AV/2 + 25$$

AV = Ancho de vano
AP = Ancho de puerta
HP = Altura de puerta
HV = Altura de vano

$$HP = HV - 38 \quad | \quad HP = HV - 33$$

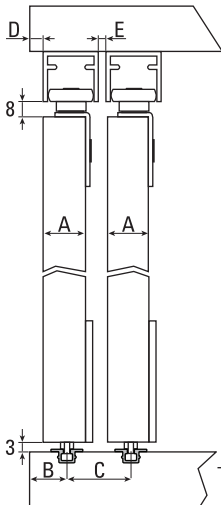

Riel Embutido CX
Trilho Embutido CX
Inlaid Carrier Track

A	B	C	D	E
18	16	26	6	3
20	18	28	8	5
22	20	30	10	7
25	23	33	13	10
30	28	38	18	15
35	33	43	23	20

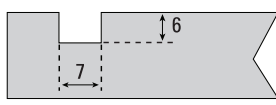

mm	Decimal inches	Aprox Fraction	mm	Decimal inches	Aprox Fraction
1	0.0394	3/64	6	0.2362	15/64
2	0.0787	5/64	7	0.2756	9/32
3	0.1181	1/8	8	0.3150	5/16
4	0.1575	5/32	9	0.3543	23/64
5	0.1969	13/64	10	0.3937	25/64

Todas las medidas expresadas en milímetros
Todas as medidas estão em milímetros.
All measurements in millimeters.

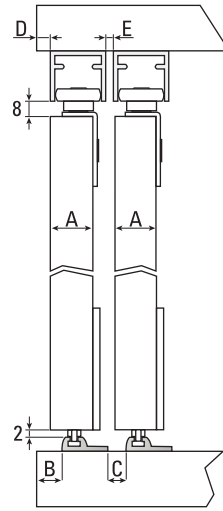

Riel AL CD50 CX
Trilho CD50 CX
Carrier Track CD50 CX



3.5x20mm
(#6x3/4)
* No incluido.
* Não incluido.
* No included.

A	B	C	D	E
18	11	6	6	3
20	13	8	8	5
22	15	10	10	7
25	18	13	13	10
30	23	18	18	15
35	28	23	23	20

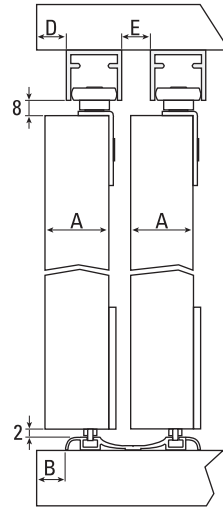
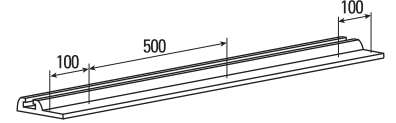

Riel AL Doble CX30
Trilho Duplo CX30
Double Carrier Track CX30

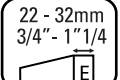

3.5x20mm
(#6x3/4)
* No incluido.
* Não incluido.
* No included.

A	B	C	D	E
22	10	-	11	17
25	11	-	14	17
30	18	-	19	17
32	20	-	21	17

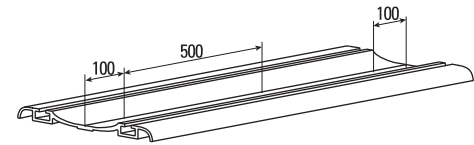

1

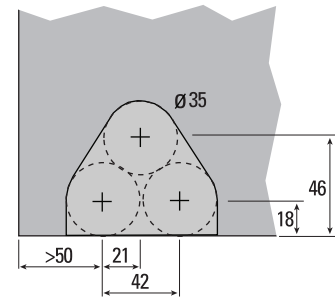
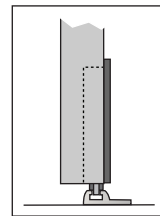

2

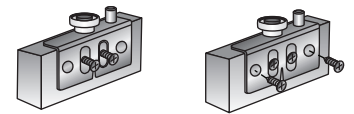
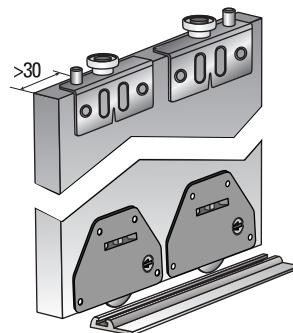

4x15
(#8x5/8")

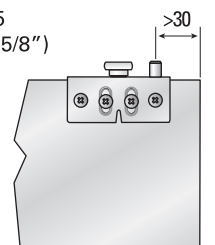

3

Instalar los frenos antes de fijar la guía al mueble.

Freio deve ser instalado no trilho guia anteriormente à colocação do mesmo no móvel.

Insert the stoppers into the guide track before installation.

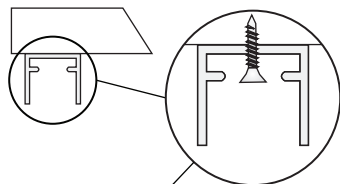
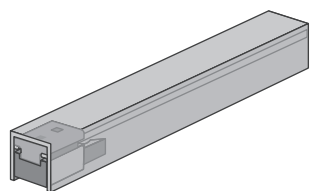

3,5x20mm (#6x3/4)
 * No incluido.
 * Não incluido.
 * No included.

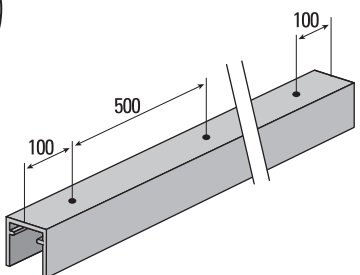
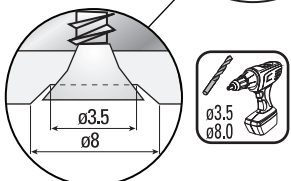

4

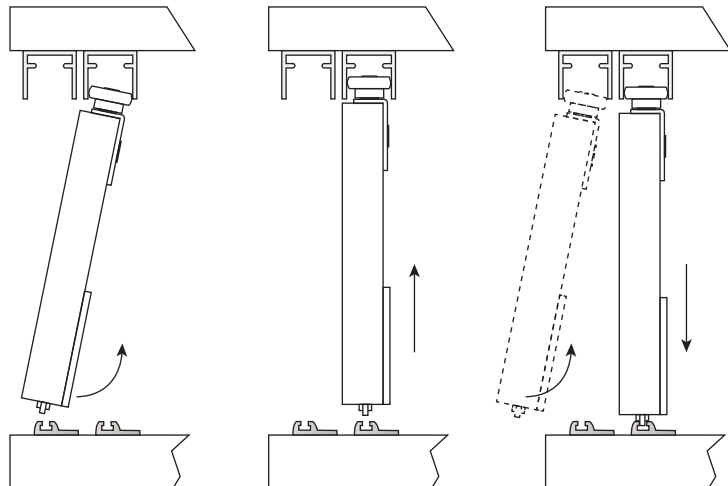

5

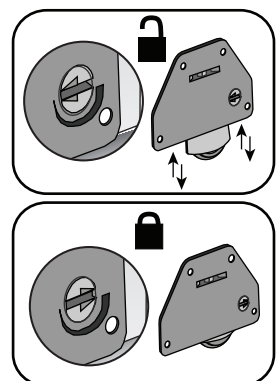
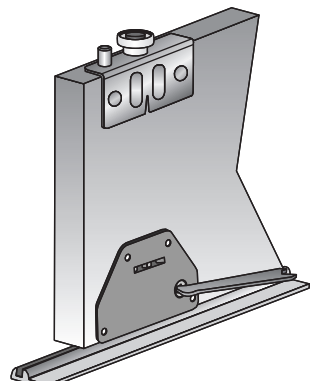

6

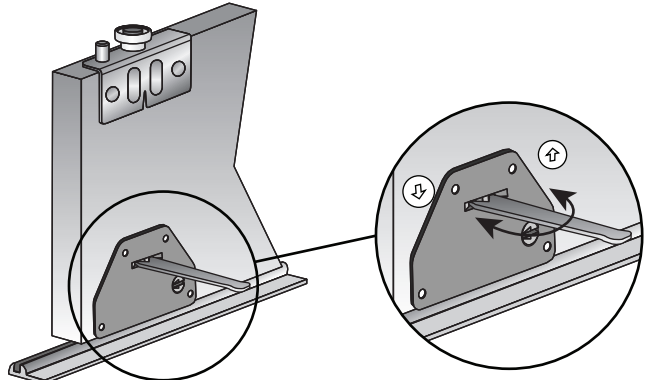

Opcional
 Opcional
 Optional

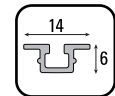
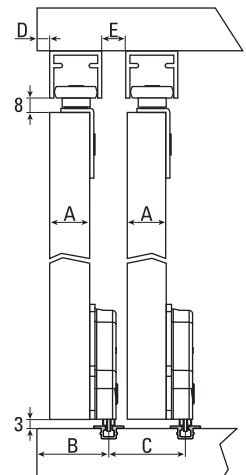
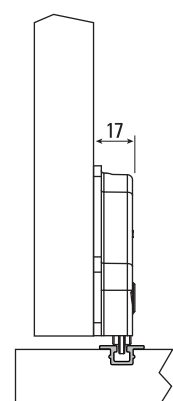
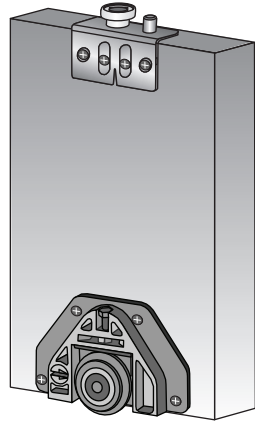

Riel Embutido CX
 Trilho Embutido CX
 Inlaid Carrier Track

A	B	C	D	E
18	33	38	6	15
20	35	40	8	17
22	37	42	10	19
25	40	45	13	22
30	45	50	18	27
35	50	55	23	32

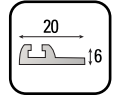
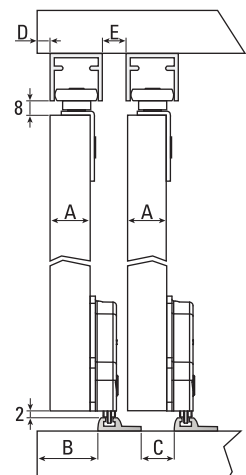

Riel AL CD50 CX
 Trilho CD50 CX
 Carrier Track CD50 CX



3,5x20mm (#6x3/4)
 * No incluido.
 * Não incluido.
 * No included.

A	B	C	D	E
18	28	18	6	15
20	30	20	8	17
22	32	22	10	19
25	35	25	13	22
30	40	30	18	27
35	45	35	23	32

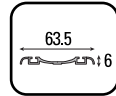
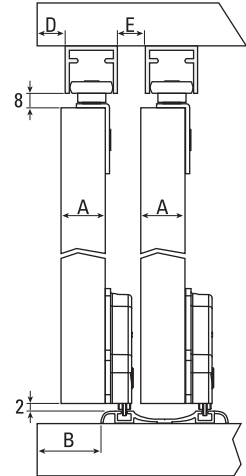

Riel AL Doble CX30
 Trilho Duplo CX30
 Double Carrier Track CX30

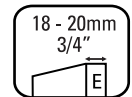

3,5x20mm (#6x3/4)
 * No incluido.
 * Não incluido.
 * No included.

A	B	C	D	E
18	22	-	7	17
20	24	-	9	17

V261119

OP

www.ducasseindustrial.com

